

AERODINÂMICA

EQUIPAMENTOS INDUSTRIAIS

FLANGES

Norma DIN / ISO 2536

Dimensional

| d mm | DN mm | pol | PN | D | a | k | b | l | | Nr. Furos |
|---------|----------|-------|----|-----|-----|-----|----|----|--|--------------|
| 20 | 15 | 1/2 | 10 | 95 | 28 | 65 | 11 | 14 | | 4 |
| 25 | 20 | 3/4 | 10 | 105 | 34 | 75 | 12 | 14 | | 4 |
| 32 | 25 | 1 | 10 | 115 | 42 | 85 | 14 | 14 | | 4 |
| 40 | 32 | 1 1/4 | 10 | 140 | 51 | 100 | 15 | 18 | | 4 |
| 50 | 40 | 1 1/2 | 10 | 150 | 62 | 110 | 16 | 18 | | 4 |
| 63 | 50 | 2 | 10 | 165 | 78 | 125 | 18 | 18 | | 4 |
| 75 | 65 | 2 1/2 | 10 | 185 | 92 | 145 | 19 | 18 | | 4 |
| 90 | 80 | 3 | 10 | 200 | 110 | 160 | 20 | 18 | | 8 |
| 110 | 100 | 4 | 10 | 220 | 133 | 180 | 22 | 18 | | 8 |
| 140 | 125 | 5 | 10 | 250 | 167 | 210 | 26 | 18 | | 8 |
| 160 | 150 | 6 | 10 | 285 | 190 | 240 | 28 | 22 | | 8 |
| 225 | 200 | 8 | 10 | 340 | 250 | 295 | 32 | 22 | | 8 |
| 280 | 250 | 10 | 6 | 395 | 308 | 350 | 36 | 22 | | 12 |
| 315 | 300 | 12 | 6 | 445 | 345 | 400 | 36 | 22 | | 12 |

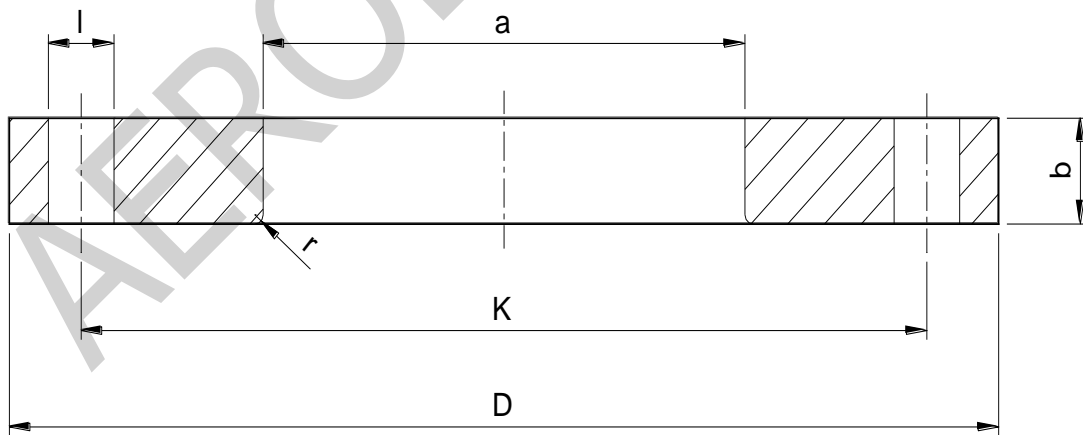

Referência do material: PVC

AERODINÂMICA EQUIPAMENTOS INDUSTRIAIS

vendas@aerodinamica.com

www.aerodinamica.com